



£300,000

The Chase, Derby DE21 5AS

Semi-Detached House | 2 Bedrooms | 1 Bathroom

01773 832355

DERBYSHIRE
PROPERTIES
SALES & LETTINGS

www.derbyshireproperties.com



Step Inside

Key Features

- GUIDE PRICE £300,000 - £325,000
- Stunning property with an exquisite interior
- Superb open-plan living space with Karndean flooring
- Quality re-fitted kitchen with integrated appliances
- Dining Area with charming brick fireplace
- Two double bedrooms & stylish re-fitted shower room
- Ecclesbourne School Catchment
- Off-road parking to the fore
- Generous south-west facing rear garden
- Sympathetically renovated to enhance the charm
- Wonderful location with a range of amenities

Property Description

GUIDE PRICE £300,000 - £325,000 Having been renovated to the highest specification to provide a home that is ready to move into a wonderful, sought after village location.

Main Particulars

GUIDE PRICE £300,000 - £325,000

Derbyshire Properties have the pleasure of bringing to market with truly beautiful home with an exquisite interior. The open-plan living space provides a comfortable living area with large bay window and Karndean flooring. High-specification kitchen with integrated appliances and island creating further preparation space. Dining area with a charming brick-built fireplace and French doors providing an outlook over the rear garden. To the first floor there is a galleried landing with home office area, two double bedrooms and re-fitted stylish shower room with large walk-in shower. Tastefully decorated throughout and sympathetically renovated to enhance the charm of this lovely home. Off-road parking to the front and generous rear garden enjoying a south-westerly aspect. Little Eaton is a much sought-after location with a range of shops, café, garden centre and public houses. Conveniently located for Derby city centre, the A38, M1 & A6. Viewing highly recommended to appreciate the quality of this lovely home.

Ground Floor

Accommodation

The property is approached via a contemporary exterior door into:

Superb Living Area

5.36m x 4.01m (17' 7" x 13' 2") A beautiful welcoming room with recessed spotlights to ceiling, light oak effect Karndean flooring with underfloor heating. televisionaerial point, telephone point, double glazed bay window to front elevation allowing plenty of natural light to flood into this room. Stairs leading to first floor with decorative balustrade and open-plan aspect into:

Stunning Dining Kitchen Area

5.35m x 3.59m (17' 7" x 11' 9") appointed with a quality range of solid wood eye and base level units with wood effect work surfaces over. Island creating further preparation space with Bora induction hob and in-built extractor. Porcelain sink unit with Quooker mixer taps. Integrated appliances including Neff hide and slide electric fan oven, combination oven/microwave, wine cooler, dishwasher, fridge/freezer, washer dryer and recycling bins. Double glazed window to rear elevation and double glazed exterior door to side.

The focal point of the dining area is an exposed brick feature fireplace, Karndean floor continuing from the lounge area, recessed spotlights to ceiling, storage cupboard housing the Baxi combi boiler and French doors providing access onto the impressive rear garden.

First floor

Galleried Landing

3.58m x 1.76m (11' 9" x 5' 9") with recessed spotlights to ceiling, central heating radiator, loft hatch providing access to the roof void, double glazed window to front elevation and home office area.

Bedroom One

3.59m x 3.45m (11' 9" x 11' 4") Enjoying a delightful outlook to the rear elevation, recessed spotlights to ceiling, television aerial point and central heating radiator.

Bedroom Two

3.45m x 3.32m (11' 4" x 10' 11") with recessed spotlights to ceiling, central heating radiator and double glazed window to front elevation.

Stylish Re-fitted Shower Room

2.48m x 1.77m (8' 2" x 5' 10") appointed with a walk-in shower with glass shower screen and thermostatic shower over. Vanity wash hand basin with storage beneath and close-coupled WC. Complementary wall tiling and natural stone floor tiling. Double glazed window, heated towel rail, extractor fan and illuminated mirror.

Outside

To the front of the property is a block-paved driveway providing off-road parking. Side access gate leading onto the generous rear garden commencing with a paved patio area and vast lawn with stocked border containing a variety of shrubs and bushes. Fully enclosed, with a sunny aspect making this ideal for alfresco entertaining.

Disclaimer

1. MONEY LAUNDERING REGULATIONS - Intending purchasers will be asked to produce identification documentation at a later stage and we would ask for your co-operation in order that there will be no delay in agreeing the sale.
- 2: These particulars do not constitute part or all of an offer or contract.
- 3: The measurements indicated are supplied for guidance only and as such must be considered incorrect.
- 4: Potential buyers are advised to recheck the measurements before committing to any expense.
- 5: Derbyshire Properties have not tested any apparatus, equipment, fixtures, fittings or services and it is the buyers interests to check the working condition of any appliances.
- 6: Derbyshire Properties have not sought to verify the legal title of the property and the buyers must obtain verification from their solicitor.



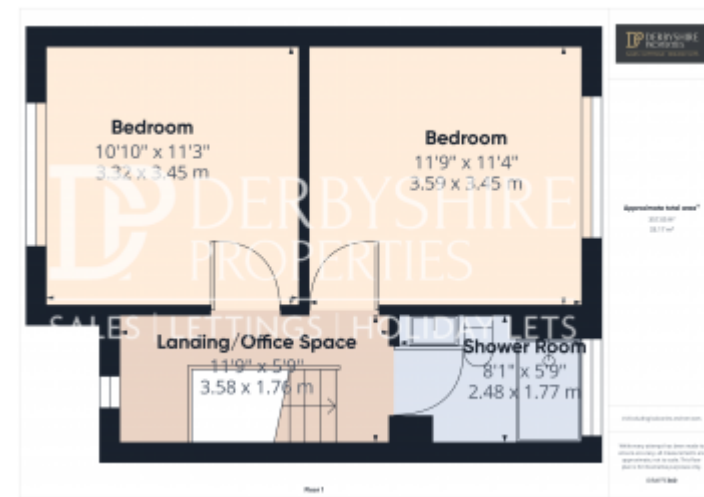
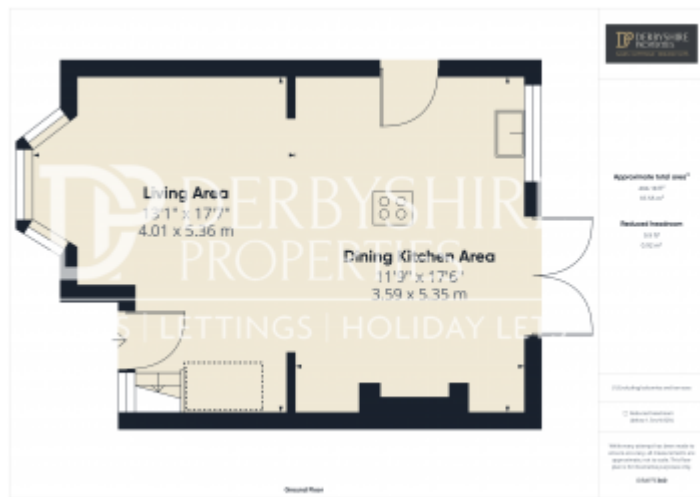

This floorplan is for illustrative purposes only and the location of doors, windows and other items are approximate.

Agents notes: All measurements are approximate and for general guidance only and whilst every attempt has been made to ensure accuracy, they must not be relied on. The fixtures, fittings and appliances referred to have not been tested and therefore no guarantee can be given that they are in working order. Internal photographs are reproduced for general information and it must not be inferred that any item shown is included with the property. Copyright © 2025 05458547 Registered Office: , 9 Bridge Street Belper Derbyshire DE56 1AY

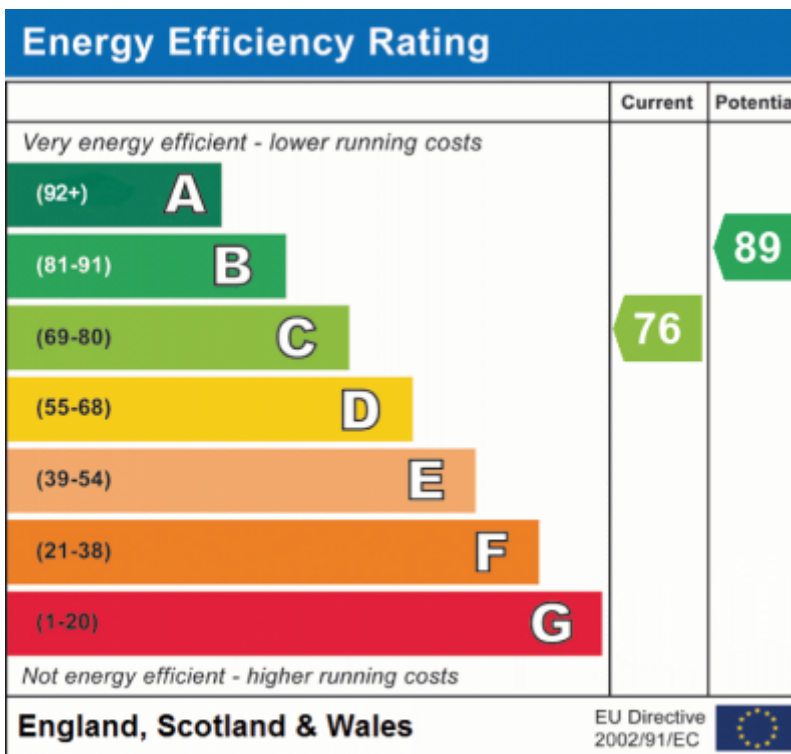

Telephone: 01773 832355



www.derbyshireproperties.com